

REPORT OF COMPLETED WORKS - SEACOAST FORTIFICATIONS
(Searchlights)

COAST DEFENSES OF SANDY HOOK
FORT HANCOCK
SEARCHLIGHT NO. -- 1

Form 4.

Corrected to Sept. 28, 1921. Size 60" ~~portable or fixed~~

PROJECTOR

Location: In storehouse at Fort Hancock, N.J.
 Manufacturer: G.E. Co.,
 Type of projector: E.C.
 Form of projector: C
 Serial No. of projector ...: 3403 ①
 Type of lamp: H
 Model of lamp: Special 41535
 Serial No. of lamp: 3609
 Electric or hand control ..: Both
 Material of mirror: Glass
 Date received in district ..: 1905
 From whom received: ---
 Age of mirror: 16 years (about)
 Condition of mirror: Good.
 Date last repaired: ---
 Switchboard, Serial No.: ---

CABLES #

Power plant to searchlight :
 Type :
 Length and size :
 In conduits or in air :
 Controller to light :
 Type :
 Length and size :
 In conduit or in air :
 Aux. controller to light .. :
 Length and size :
 In conduit or in air :

INSTALLATION

: General character :
 : Date Transferred to :
 : troops : April 29, 1905.
 : Cost to that date :
 : Shelter :
 : Materials of construction ..: :
 : Interior dimensions :
 : Height and type of tower ...: :
 : Means by which projector ...: :
 : is placed in operating :
 : position :
 : Reference axis of projector :
 : in operating position :
 : Kind of protection in :
 : operating position :
 : Concealment of day shelter ..: :
 : from approach channel :
 : Dates & cost of extensive :
 : remodeling or reconstruc- :
 : tion :
POWER PLANT :
 : Location :
 : Maximum demand KW :
 : Type and size :
CONTROLLERS :
 : Location :
 : Type :
 : Form :
 : Serial No. :
 : How protected or con- :
 : cealed :

Note:- This Searchlight removed from Position No. 3 near Battery Gunnison and placed in storage in April, 1921.

① See 1st Ind., 470.31 A - 2345, 2/26/34

S/L # 3403 is no longer stored at Ft. Hancock, having been removed by C.A.C. survey several years ago. (Note: Check of serial number of S/L on railroad car is not possible as plate is removed.)

REPORT OF COMPLETED WORKS - SEACOAST FORTIFICATIONS
(Fire control and torpedo structures)

COAST DEFENSES OF SANDY HOOK
FORT HANCOCK
STRUCTURE Frame shelter, S/L No. 1

Form 2 Corrected to March 13, 1923.

Location	At S/L No. 1, Port Hancock, N.J.	Type of data transmission	
Date of transfer	February 27, 1923.	Date of transfer	
Cost to date	\$275.00	Cost of data transmission equipment	
Type of construction	7/8" sheathing, waterproofed	For tide stations give description of tide gage	
(a) Roof	Frame	For datum points give Forts from which visible	
(b) Remainder of building	By sand dunes	For dormitories give stations served	
How concealed	By sand dunes	For cable hut give S. C. type	
How protected	By sand dunes		
Height above concealment	Does not extend above concealment.		
Height above protection	Does not extend above protection.		
Conspicuous at yards	Not conspicuous		
Source of electric current	No current required for		
Kilowatts required	shelter; for SL data see Form 4.		
Type of lighting fixtures			
How heated	Not heated		
Connected to water mains	No		
Connected to sewer	No.		
Type of latrine	None		
Permanent or temporary installation	Semi-permanent		
Present condition	Good		
Reference of site			
Reference of instrumental axis			
Type of observing instrument			
Type of plotting board			
Type and capacity of crane			
Max. dimensions of reel handled			

For blueprint showing SL No. 1 and shelter see Form No. 4.

Paste on blueprint showing plan of each story of building, giving principal dimensions including height of ceiling.

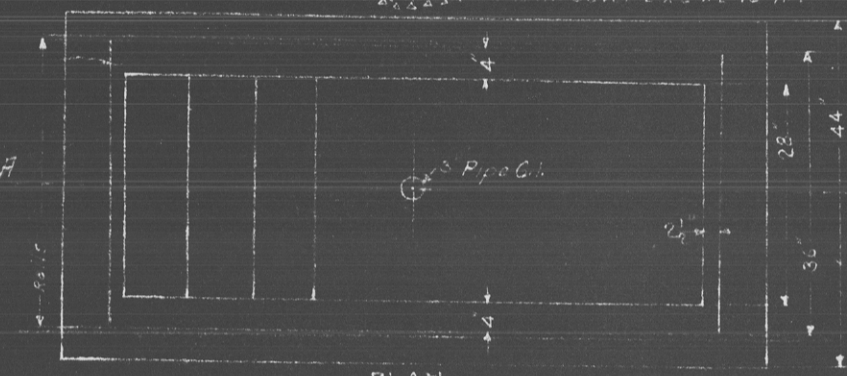
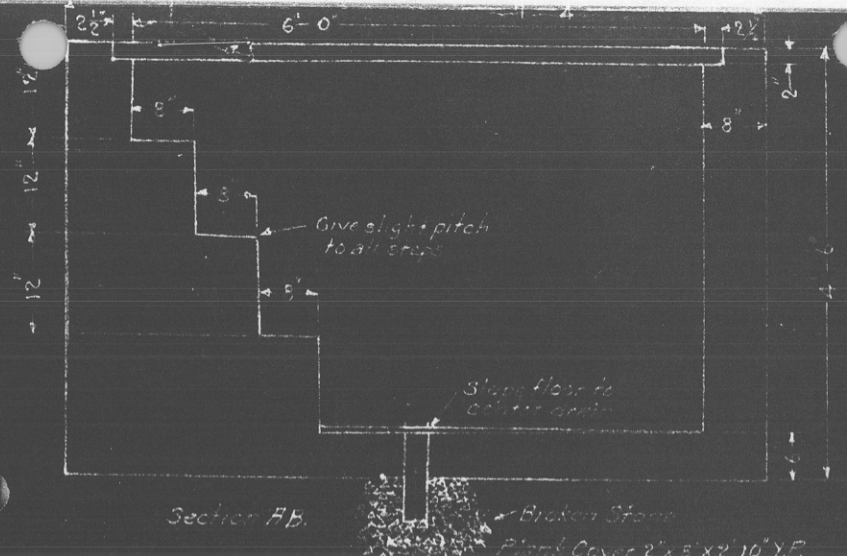

t #3.

Switchboard, Serial NC	:	from approach channel
CABLES #	:	Dates & cost of extensive
Power plant to searchlight	:	remodeling or reconstruction
Type	:	
Length and size	:	<u>POWER PLANT</u>
In conduits or in air	:	Location
Controller to light	:	Maximum demand KW
Type	:	Type and size
Length and size	:	<u>CONTROLLERS</u>
In conduit or in air	:	Location
Aux. controller to light	:	Type
Length and size	:	Form
In conduit or in air	:	Serial No.
	:	How protected or con-
	:	cealed

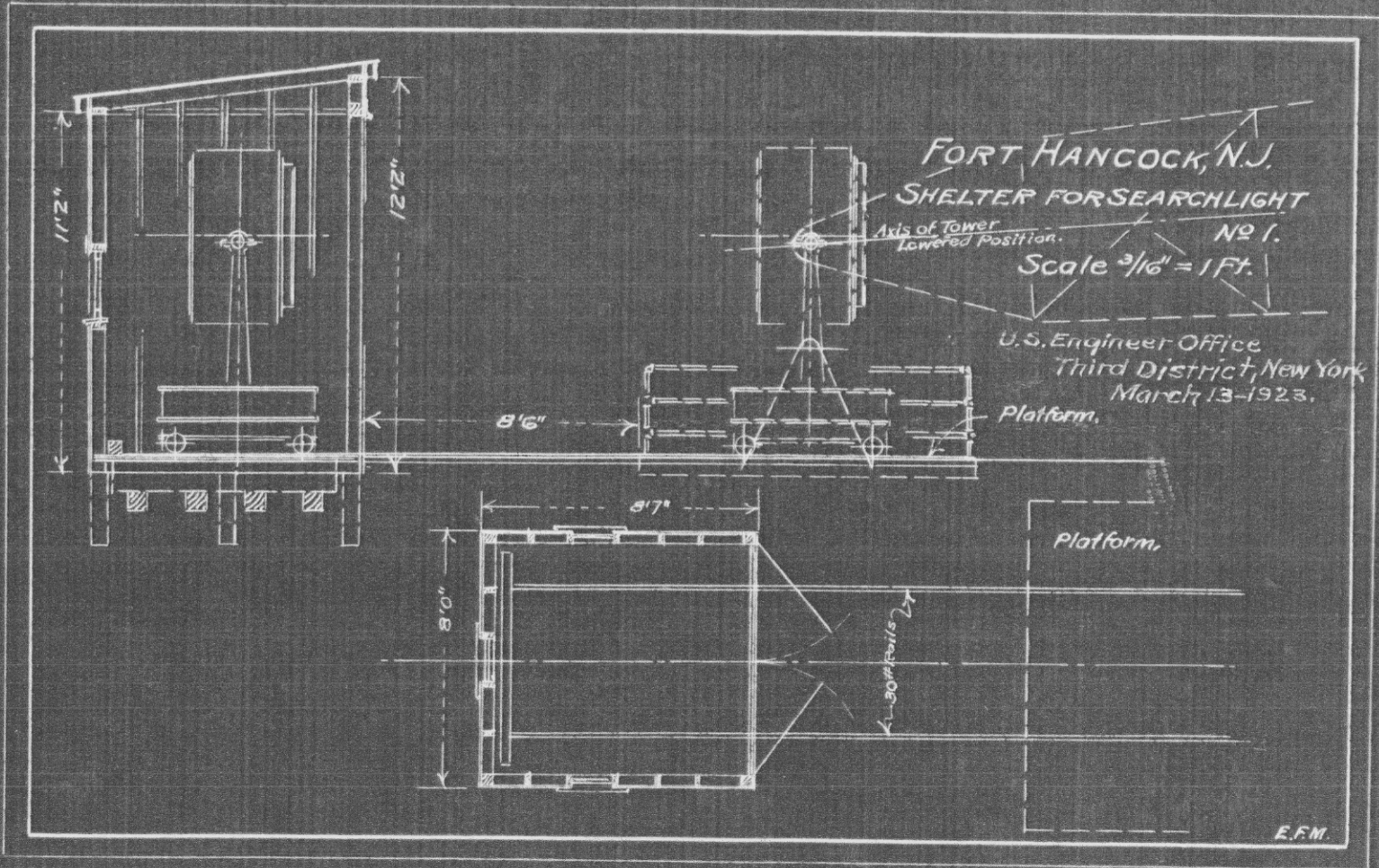

PRODUCTION OF DRAWINGS - WORK - SUPERVISOR'S OFFICE

ENCLOSURE NO. 1
LEVEL
CORRECT DRAWING OF

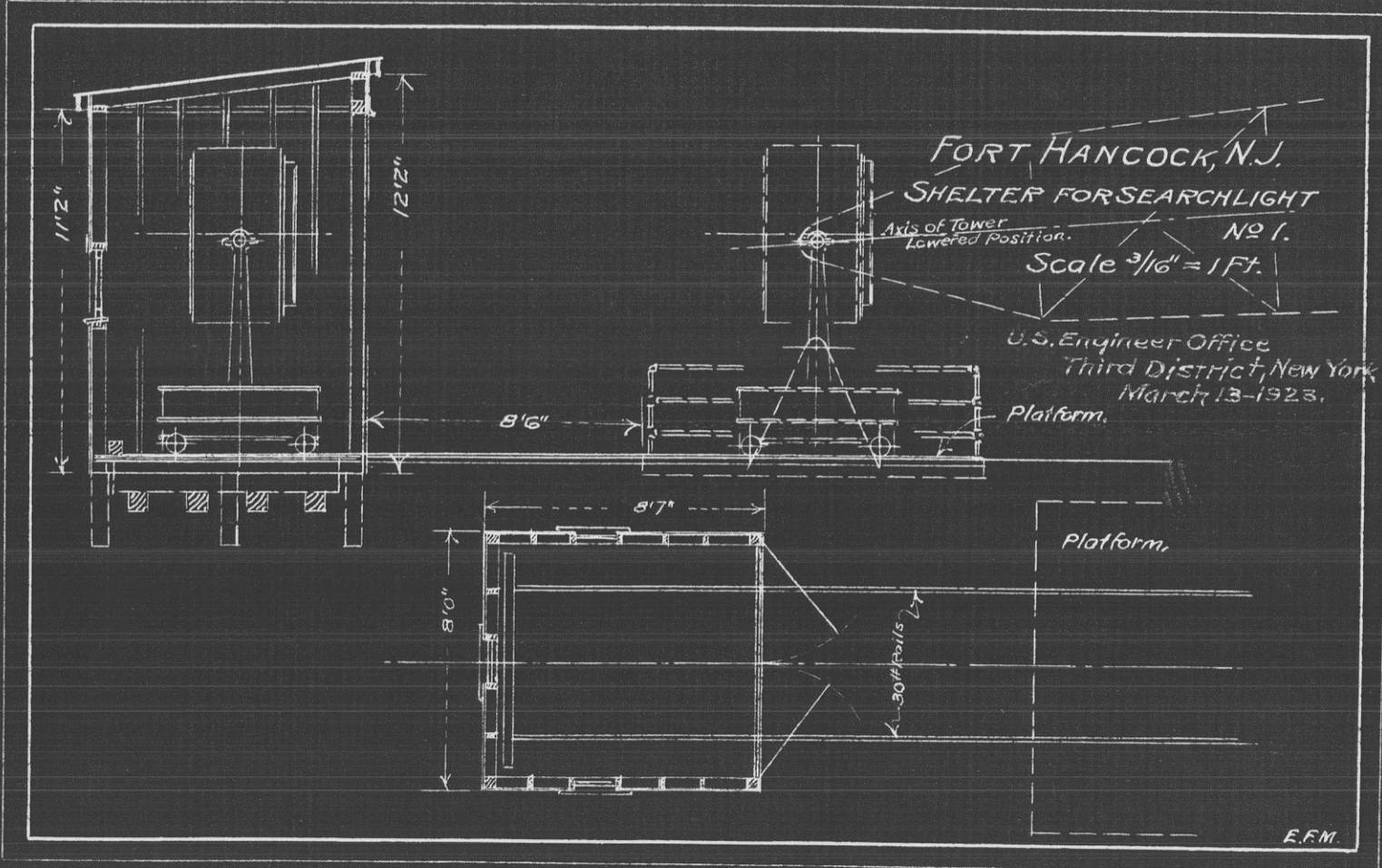

REPORT OF COMPLETED WORKS - SEACOAST FORTIFICATIONS
(Searchlights)

COAST DEFENSES OF SANDY HOOK
FORT HANCOCK
SEARCHLIGHT NO. 1

Form 4. Corrected Oct. 24, 1924. Size 60" fixed.

PROJECTOR	: On Strauss Tower No. 1	INSTALLATION	:
Location.....	: 900 ft. south of Secondary station.	General character	: Disappearing tower
Manufacturer	: G.E. Company.	Date Transferred to troops..	: Aug. 14, 1918.
Type of projector	: E.C. 60"	Cost to that date	: \$3,800.00 Projector - \$5,435.72 Tow-
Form of projector	: N 33 (1)	Shelter	:
Serial No. of projector	: 8487	Materials of construction..	: Steel, frame, metal lath, reinforced concrete.
Type of lamp	: Sperry V type	Interior dimensions	: 10' x 25'
Model of lamp	: 4	Height and type of tower ...	: 64' to axis of projector - Strauss Bascule lift.
Serial No. of lamp	: 103	Means by which projector	: Electric motor or hand operation
Electric or hand control ...	: Both	is placed in operating	: of towers.
Material of mirror	: Glass	position	:
Date received in District ..	: Feb. 14, 1913.	Reference axis of projector	: 74' (MLW)
From whom received	: D.E.O., New London, Conn.	in operating position	:
Age of mirror	: About 11 years.	Kind of protection in	: No protection to searchlight. Por-
Condition of mirror	: Slight crack at bot. edge	operating position	: tion of tower protected by sand.
Date last repaired'	: -	Concealment of day shelter	:
Switchboard, Serial No.	: 103360	from approach channel	: BY sand dunes and trees.
CABLES #		Dates & cost of extensive	: Floor lowered Mar. 1919.
Power plant to searchlight:	From Reserve Power Plant	remodeling or reconstruction:	: \$600.00
Type	: 2-211,600 C.M. Duplex lead each leg.	POWER PLANT	
Length and size	: 674 ft.-2 @ 211,600 C.M. each	Location	: Between searchlights 1 and 2. Auxil-
In conduits or in air	: Conduit	Maximum demand KW.....	: iary power plant 300 ft. So. of "P".
Controller to light	: --	Type and size	: One 25 KW Gasoline Elect. Generator
Type	:)		: One 25 KW Auxiliary for Searchlights 1 and 2)
Length and size	:)	CONTROLLERS	
In conduit or in air	: -- As listed on attached	Location	: Booth in B" Reynolds.
Aux. controller to light...)	: sheet.	Type.....	: DL 83534
Length and size	:)	Form	: N2
In conduit or in air	:)	Serial No.	: 12255 in B" Reynolds.
		How protected or concealed ..	: No protection.

NOTE: Power plant for S.L. 1 & 2 (2-25 K.W. sets) and Reserve Power plant (1-25 K.W. set) are each cross-connected and connected to S.L. 1 & 2.

① RETURNED TO SCHENECTADY Q.M. DEPOT for SALVAGE 12/14/42

(Electric Plants)

Fort Hancock
Reserve Power for Searchlights Nos. 1 and 2.

Form 5

Corrected to Nov. 1st, 1922.

	Serial No.	Type	Size	Mfgr.	Date of Transfer	Cost	Condition	RPM	Belt or direct drive	Radiator for Engine No.	Fuel	Switchboard Material	No. of Panels
Boiler													
No. 1													
No. 2													
No. 3													
Gasoline Engine													
No. 1	17444	G.M.12	53/54	Genl. Elec.	July 28, 1922.		Good	560	D.D.		Gasoline		
No. 2													
No. 3													
Generator													
No. 1	923926	G.M.12	25KW	"			Good	560					
No. 2													
No. 3													
Radiator													
No. 1	16941	F.F.		"						17444			
No. 2													
No. 3													
Fan Motor													
No. 1	932894			"				950					
No. 2													
No. 3													
Switchboard													
No. 1	682 (For S.L.No.1)											Composition	1
No. 2	667 (" " " 2)											"	1
S.L. Controller Panel													
No. 1	D.L.1763095 CR											"	1
No. 2	5029-9												
No. 3													
Auxiliaries													
No. 1													
No. 2													
No. 3													

NOTE: Reserve Power Plant 25 K.W. set is cross-connected to 25 K.W. sets in Power Plant (location between S.L. 1 & 2).

DISTRIBUTION OF K.W. 20 K.W. to either S.L. #1 or S.L. #2.

WAR DEPARTMENT.

CORPS OF ENGINEERS, U.S. ARMY.

FORT HANCOCK, N. J.

RESERVE POWER PLANT
FOR
SEARCHLIGHTS Nos 1 AND 2.

MAY 30-1922

SCALE 1/8" = 1'-0"

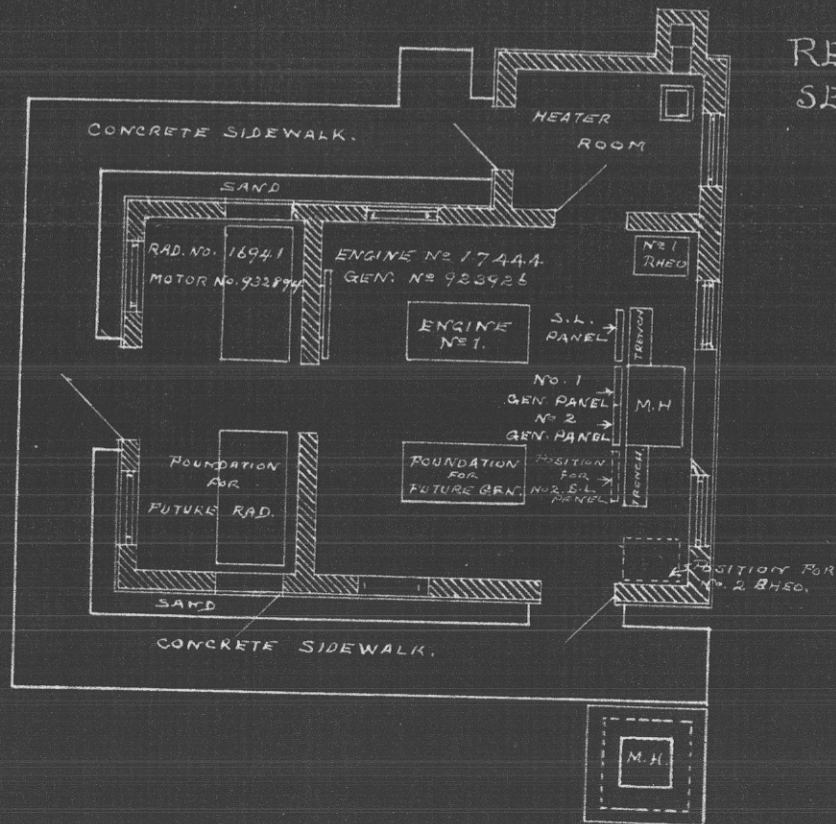

REPORT OF COMPLETED WORKS - SEACOAST FORTIFICATIONS
(Searchlights)

COAST DEFENSES OF SANDY HOOK
FORT HANCOCK
SEARCHLIGHT NO. 2

REC'D OFFICE DIV. ENG. OCT 30 1924
N. E. DIVISION-NEW YORK

Form 4.

Corrected to Oct. 24, 1924.

Size 60" fixed.

<u>PROJECTOR</u>	On Type C Tower No. 2	<u>:INSTALLATION</u>
Location	:550' ft. South of Secondary Station	: General character
Manufacturer	: G.E. Co.	: Date Transferred to
Type of projector	: E.C. 60"	: troops
Form of projector	: N 5	: Cost to that date
Serial No. of projector	: 9447	: Shelter
Type of lamp	: Sperry V type	: Materials of construction ..
Model of lamp	: 4	: Interior dimensions
Serial No. of lamp	: 101	: Height and type of tower ..
Electric or hand control ..	: Both	: Means by which projector ..
Material of mirror	: Glass	: is placed in operating ..
Date received in district ..	: Nov. 11, 1916.	: position
From whom received	: General Purchasing Office,	: Reference axis of projector:
Age of mirror	: Panama Canal.	: in operating position
Condition of mirror	: About 6 years.	: Kind of protection in
Date last repaired	: Good	: operating position
Switchboard. Serial No.	: 103365	: Concealment of day shelter :
<u>CABLES#</u>		: from approach channel
Power Plant to searchlight:	(From Reserve Power Plant)	: Dates & cost of extensive :
Type	: 1-Duplex 211,600 C.M. L.C.	: remodeling or reconstruc-
Length and size	: 380'	: tion
In conduits or in air	: In Conduit	<u>:POWER PLANT</u>
Controller to light	: --	: Location
Type	: --)	: Maximum demand KW.....
Length and size	: --) As listed on	: Type and size
In conduit or in air	: --) attached sheet.	: One 25 KW set = Gasline Electric
Aux. controller to light :	: --)	: Auxiliary for searchlights 1 and 2
Length and size	: --)	<u>:CONTROLLERS</u>
In conduit or in air	: --)	: Location
		: Type
		: Form
		: Serial No.
		: How protected or concealed:

NOTE: Power plant for S.L. 1 & 2 (2-25 K.W. sets) and Reserve Power Plant (1-25 K.W. set) are each cross-connected and connected to S.L. 1 & 2.

REPORT OF COMPLETED WORKS - SEACOAST FORTIFICATIONS.
(Fire control and torpedo structures)

COAST DEFENSES OF Sandy Hook

FORT Fort Hancock, N.J.

Form 2

Corrected to

July 1, 1921

STRUCTURE Movable shelter for searchlight No.2

Location	: About 700 ft. southerly : from Ft. No.1 & Ft. Reynolds	: Type of data transmission	: -
Date of transfer	: March 24, 1921	: Date of transfer	: -
Cost to date	: \$400.00	: Cost of data transmission	: -
Type of construction	: Rubberoid	: equipment.	: -
(a) Roof	: Frame - T.&G. sheathing	: For tide stations give	: -
(b) Remainder of building	: None	: description of tide	: -
How concealed	: None	: gauge.	: -
How protected	: None	: For datum points give Forts:	: -
Height above concealment	: "	: from which visible	: -
Height above protection	: "	: For dormitories give sta-	: -
Conspicuous at 500 \dagger yards	: Yes	: tions served	: -
Source of electric current	: None	: For cable hut give S. C. type:	: -
Kilowatts required	: -		
Type of lighting fixtures	: -		
How heated	: No heat		
Connected to water mains	: No		
Connected to sewer	: No		
Type of latrine	: None		
Permanent or temporary installation	: Permanent		
Present condition	: Good		
Reference of site	: 10.3 ft. above		
Reference of instrumental axis	: -		
Type of observing instrument	: -		
Type of plotting board	: -		
Type and capacity of crane	: -		
Max. dimensions of reel handled	: -		

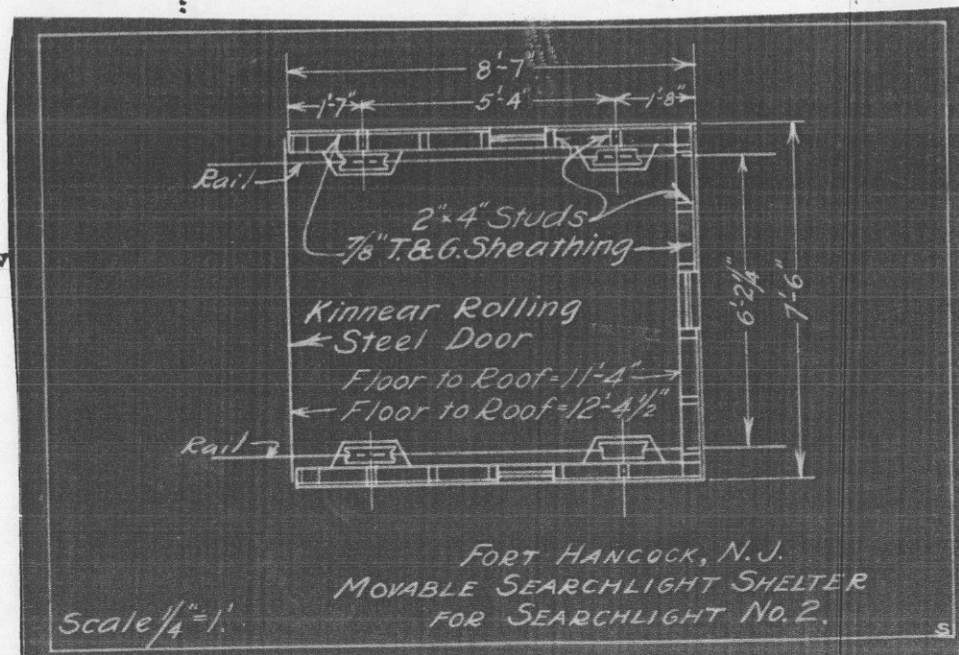

REPORT OF COMPLETED WORKS - SEACOAST FORTIFICATIONS.
(Fire control and torpedo structures)

COAST DEFENSES OF Sandy Hook

FORT Fort Hancock, N.J.

Form 2

Corrected to

July 1, 1921

STRUCTURE Movable shelter for searchlight No.2

Location	: About 700 ft. southerly : from Ft. No. 1 & Bl Reynolds	Type of data transmission	: -
Date of transfer	: March 24, 1921	Date of transfer	: -
Cost to date	: \$400.00	Cost of data transmission	: -
Type of construction	: Rubberoid	equipment.	: -
(a) Roof	: Frame - T.&G. sheathing	For tide stations give	: -
(b) Remainder of building	: None	description of tide	: -
How concealed	: None	gauge.	: -
How protected	: None	For datum points give Forts:	: -
Height above concealment	: "	from which visible	: -
Height above protection	: "	For dormitories give sta-	: -
Conspicuous at 500 f yards	: Yes	tions served	: -
Source of electric current	: None	For cable hut give S.C. type:	: -
Kilowatts required	: -		: -
Type of lighting fixtures	: -		: -
How heated	: No heat		: -
Connected to water mains	: No		: -
Connected to sewer	: No		: -
Type of latrine	: None		: -
Permanent or temporary installation	: Permanent		: -
Present condition	: Good		: -
Reference of site	: 10.3 ft. above		: -
Reference of instrumental axis	: -		: -
Type of observing instrument	: -		: -
Type of plotting board	: -		: -
Type and capacity of crane	: -		: -
Max. dimensions of reel handled	: -		: -

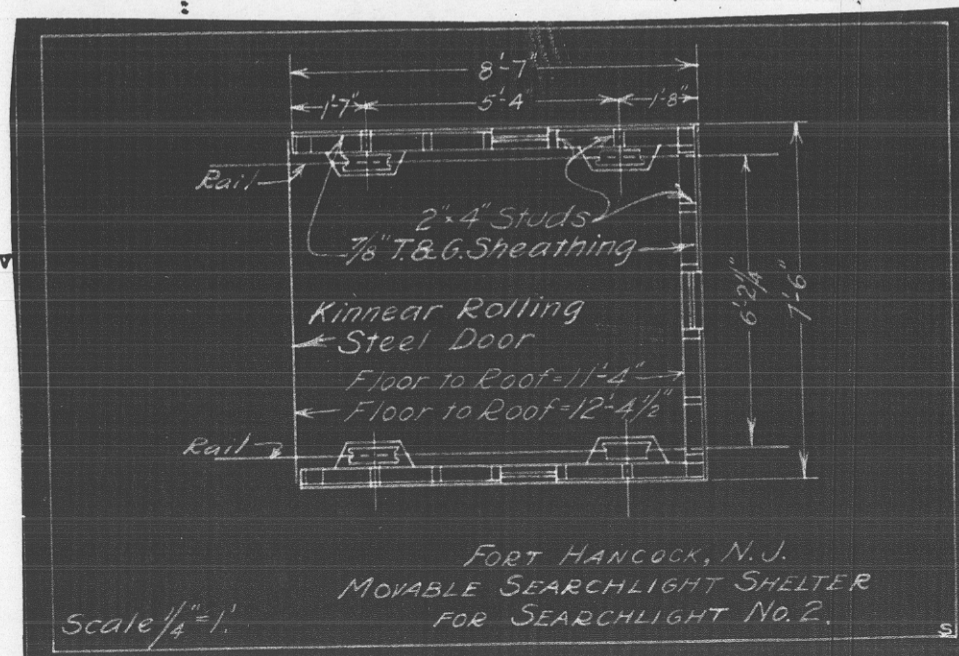

REPORT OF COMPLETED WORKS - SEACOAST FORTIFICATIONS
(Searchlights)

COAST DEFENSES OF SANDY HOOK
FORT HANCOCK
SEARCHLIGHT NO. 3 (Near Battery Gunnison)

Form 4.

Corrected to Sept. 28, 1921. Size 60" ~~Portable or~~ fixed

<p><u>PROJECTOR</u></p> <p>Location: 800 ft. south of Battery Gunnison</p> <p>Manufacturer: G.E. Co.,</p> <p>Type of projector: E.C. 60"</p> <p>Form of projector: N 5</p> <p>Serial No. of projector: 9449</p> <p>Type of lamp: Sperry H.I. 60" Mark V</p> <p>Model of lamp: No. 10</p> <p>Serial No. of lamp: 406</p> <p>Electric or hand control ...: Both.</p> <p>Material of mirror: Glass</p> <p>Date received in district ..: (Searchlight received in 1917 - Sperry lamp Oct. 29, 1920.) Washington Barracks</p> <p>From whom received: (1920.) Washington Barracks</p> <p>Age of mirror: About 4 years.</p> <p>Condition of mirror: Good.</p> <p>Date last repaired: --</p> <p>Switchboard, Serial No.: 150825</p> <p><u>TABLES #</u></p> <p>Power plant to searchlight :</p> <p>Type: Concentric</p> <p>Length and size: 440' - 204,620 C.M.</p> <p>In conduits or in air: In one hole conduit.</p> <p>Controller to light</p> <p>Type: R.C. Braided - 9 conductor</p> <p>Length and size: 800 ft. - 9 conductor.</p> <p>In conduit or in air: On pole line.</p> <p>Aux. controller to light ...: None.</p> <p>Length and size</p> <p>In conduit or in air</p>	<p><u>INSTALLATION</u></p> <p>: General character: <u>On flat car in Frame Shelter.</u></p> <p>: Date Transferred to: Original searchlgt. Aug. 28, 1908 : troops: Sperry H.I. April 26, 1921.</p> <p>: Cost to that date: " " COST \$2908.</p> <p>: Shelter</p> <p>: Materials of construction ..: Wood (Concrete floor)</p> <p>: Interior dimensions: 20' x 14' x 12' high.</p> <p>: Height and type of tower ...: No tower. Shelter on 20' fill</p> <p>: Means by which projector : Searchlight on small flat car is : is placed in operating : pushed by hand on rails. : position</p> <p>: Reference axis of projector: : in operating position: --- 37 ft. ±</p> <p>: Kind of protection in : : operating position: None.</p> <p>: Concealment of day shelter : : from approach channel: None.</p> <p>: Dates & cost of extensive : 60" S.L. (Projector 3403 originally : remodeling or reconstruc- : installed in #3 position was inter- : tion: changed for 60" S.L. (Projector 9449 : in April 1921 and the latter was : Sperryized at a cost of \$911.50 for : lamp and conversion parts and labor : \$115.05</p> <p><u>POWER PLANT</u></p> <p>: Location: 500 ft. South of Battery Gunnison</p> <p>: Maximum demand KW: 20 K.W.</p> <p>: Type and size: One 25 KW gasoline electric set.</p> <p><u>CONTROLLERS</u></p> <p>: Location</p> <p>: Type: E.C.</p> <p>: Form: D 1</p> <p>: Serial No.: 5812</p> <p>: How protected or con- : : cealed: In B.C. Station.</p>
--	---

REPORT OF COMPLETED WORKS - SEACOAST FORTIFICATIONS
(Electric Plants)

COAST DEFENSES OF SANDY HOOK
FORT HANCOCK, N.J.

POWER FOR Searchlight No. 3 (Near Battery Gunnison.)

Form 5.

Corrected to Sept. 28, 1921.

	Serial No.	Type	Size	Mfgr.	Date of transfer	Cost	Con- dition	REV or Direct Drive	Belt or Engine No.	Radiator for fuel	Switchboard Material No. of Panels
Bo r No. 1											
No. 2											
No. 3											
Engine No. 1	10891	G.M.	43/54 H.P.	G.E.Co.	Dec. 23, 1920		Fair.	560	Direct	Gasoline	
No. 2											
No. 3											
Generator No. 1	435330	M.P.C	25 K.W.	G.E.Co.	Dec. 23, 1920	\$3,291.25	"	560	"		
No. 2											
No. 3											
Radiator No. 1	10259	FF 54		G.E.Co.	Dec. 23, 1920		"			1	
No. 2											
No. 3											
Motor-Generator											
No. 1	Gov't. Serial No. 567										
No. 2											
No. 3											
Sw' hboard	200542		20" x 82"								Marble 1
Storage Battery											
Transformer											
No. 1											
No. 2											
No. 3											
Auxiliaries											
No. 1											
No. 2											
No. 3											

DISTRIBUTION OF KW.

REPORT OF COMPLETED WORKS - SEACOAST FORTIFICATION
(Electric Plants)

HARBOR DEFENSES OF SANDY HOOK
FORT HANCOCK, N.J.
POWER FOR 60" SL #3 (near Battery Gunninson)

Form 5. *with 603 (Sandy Hook)* Corrected to May 4, 1938

	Serial No.	Type	Size	Mfr.	Date of Transfer	Cost	Con- dition	RPM	Type of Drive	Radiator for En- gine No.	Fuel	Switchboard	
												Mate- rial	No. of Panels
Boiler No. 1													
" No. 2													
" No. 3													
Eng. No. 1	10901	GM-12 Form A-23	43/54 HP	G.E.Co.	Jan. 3, 1937	Bldg. 4985.08	Good	560	Direct		Gasoline		
No. 2	6850	GM-12 Form A-2	43/54 HP	G.E.Co.	" "		"	560	"		"		
No. 3													
Generator No. 1	435331	MPC 6/25 Form G	217 AMP 25 KW	G.E.Co.	"	2 units 4700. ea	Good	560	"				
No. 2	324493	MPC 6/25 Form A	217 Amp 25 KW	G.E.Co.	"		"	560	"				
No. 3													
Radiator No. 1	10270	PF54 Form B3	Amp. 23.4 3 HP (fan)	G.E.Co.	"		Good	1150		1			
No. 2	8113	PF54 Form B2	Amp. 23.1 3 HP (fan)	G.E.Co.	"		"	1150		2			
No. 3													
Motor Generator No. 1													
No. 2													
No. 3													
Switchboard #1	200487	Gov. Se- ries 513	20"x82" each										
#2	202205	Gov. Se- ries 726 C.D.G.					Good					Compos- ition	2
Storage Battery													
Transformer No. 1													
No. 2													
No. 3													
Auxiliaries No. 1													
No. 2													
No. 3													

DISTRIBUTION OF
KW. Power Plant Lights .3 KW
Searchlight 14 KW

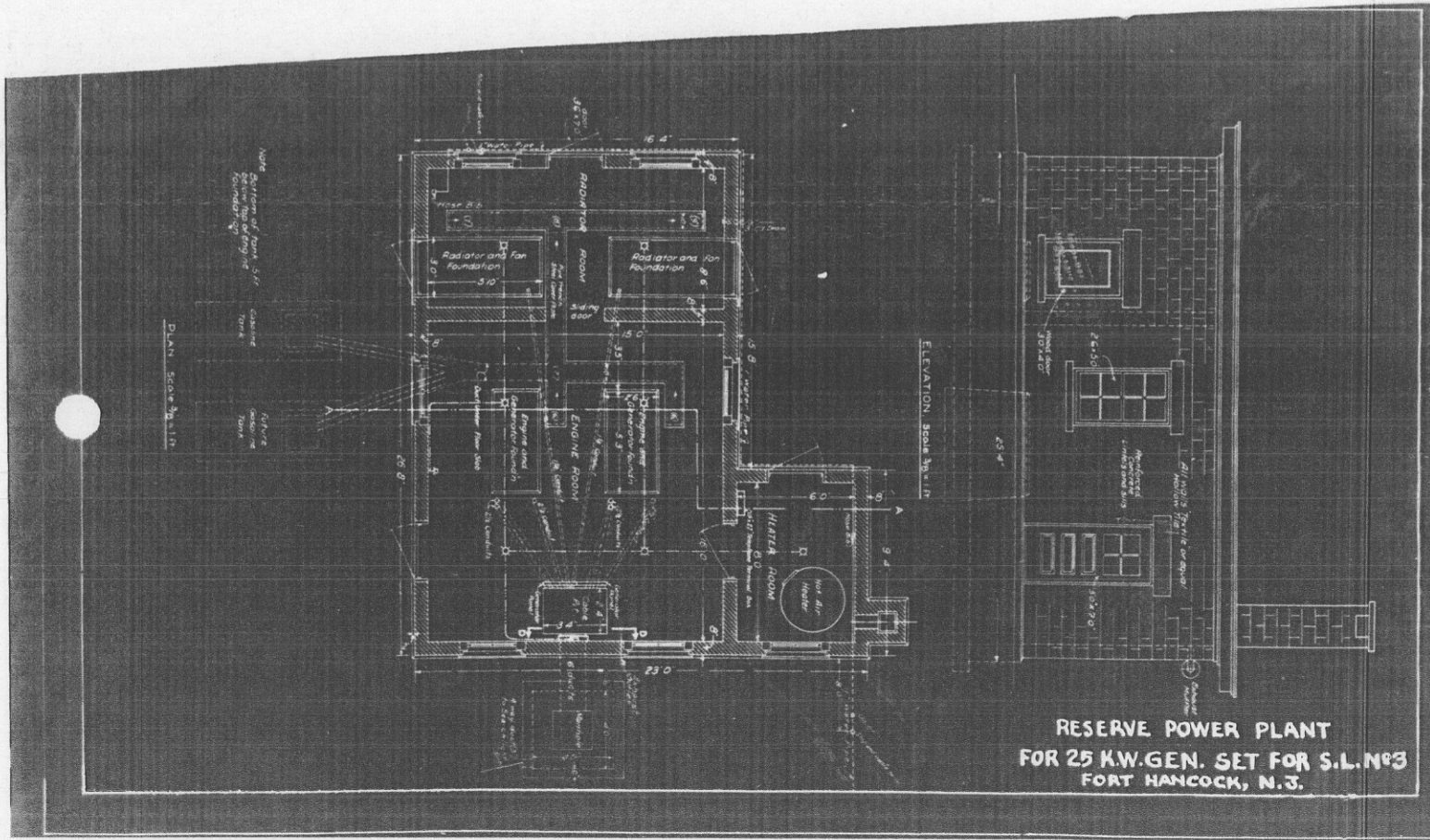

**RESERVE POWER PLANT
FOR 25 KW. GEN. SET FOR S.L. No 3
FORT HANCOCK, N.J.**

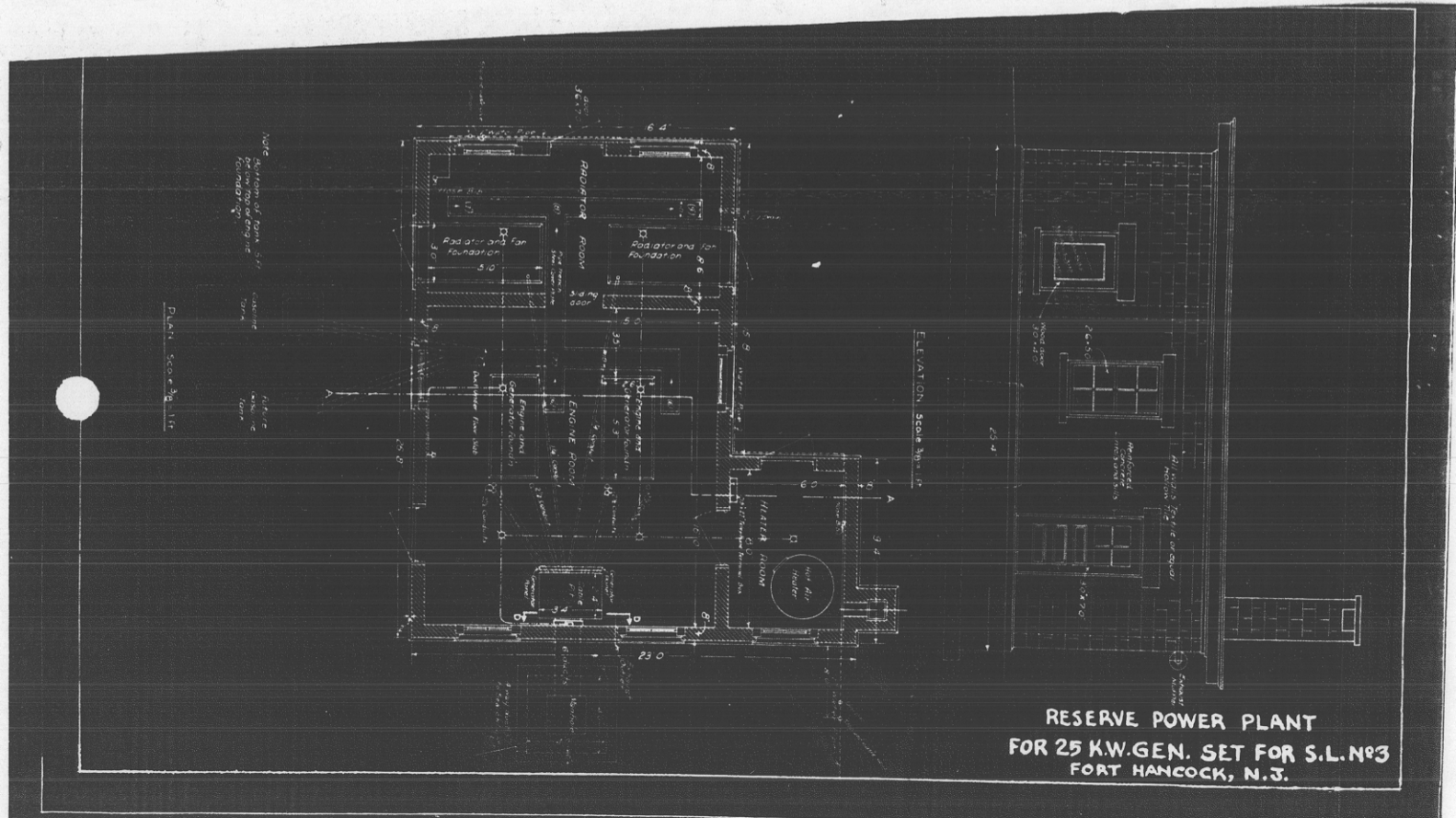

REPORT OF COMPLETED WORKS - SEACOAST FORTIFICATIONS
(Searchlights)

ASSIGNED TO T.A. Car...
Assignment of Tactical No. 4 to R.R. 5/L, approved by A.G. July 2, 1929.
17th Ind. 660 K (S.H.) 100.

COAST DEFENSES OF SANDY HOOK
FORT HANCOCK. = 5 ①
SEARCHLIGHT NO. 4 (In No. 5 Position.)

Form 4.

Corrected to Sept. 28, 1921. Size 60" Portable or fixed (at point of Sandy Hk.)

PROJECTOR	: On roof of old supplement-	INSTALLATION	: Installed in sheet iron shelter
Location	tary station at point of S. Sandy Hook.	General character	on roof of Supplementary station.
Manufacturer	G.E. Co.	Date Transferred to	Nov. 17, 1918
Type of projector	E.C. 60"	troops	---
Form of projector	N-5	Cost to that date	\$3,242.13 (Searchlight only)
Serial No. of projector	9448	Shelter	(Corrugated iron.)
Type of lamp	Sperry V type	Materials of construction	()
Model of lamp	4	Interior dimensions	12' x 9'-6" x 10'-6" high
Serial No. of lamp	106	Height and type of tower	Height of supplementary station
Electric or hand control	Both	Means by which projector	44 ft. above M.L.W.,
Material of mirror	Glass	is placed in operating	stationary.
Date received in district	June, 1915.	position	
From whom received	Purchased from G.E. Co.,	Reference axis of projector:	
Age of mirror	About 8 years.	in operating position	50.5 ft. †
Condition of mirror	Poor	Kind of protection in	
Date last repaired	---	operating position	None.
Switchboard, Serial No.	150828	Concealment of day shelter	
CABLES #		from approach channel	None.
Power plant to searchlight		Dates & cost of extensive	
Type	Lead covered	remodeling or reconstruc-	None.
Length and size	50 ft. - 225,000 C.M.	tion	
In conduits or in air	In wood'n duct.	POWER PLANT	: On first floor of old supplementary
Controller to light		Location	station.
Type	L G & A	Maximum demand KW	20 K.W.
Length and size	826 ft. - 9 conductor.	Type and size	One 25 KW gas electric set.
In conduit or in air	Pole line.	CONTROLLERS	
Aux. controller to light	None	Location	In M' Station.
Length and size	---	Type	D L 83534
In conduit or in air	---	Form	N2
		Serial No.	12230
		How protected or con-	
		cealed	---

Superseded - see Form 6 corrected
to 11/15/29

① See 1st Ind. 470.31 A-2345, 2/28/29
Now designated as #5.

600.914 (New York) (N 25866)

REPORT OF COMPLETED WORKS - SEACOAST FORTIFICATIONS.

HARBOR DEFENSES OF NEW YORK
FORT HANCOCK

ENGINEER DEPARTMENT STRUCTURES
STRUCTURE - ~~FIRE CONTROL STATION~~ - SEARCHLIGHT NO. 7

Part VI Corrected to 15 November 1943.

SPEKM-1

On this sheet list any existing structures of a permanent or semipermanent nature used wholly or in part by the Engineer Department, such as wharves, storehouses, quarters, office buildings, railroads and railroad equipment, giving for each a short description, dimensions, materials of construction, present use, location, etc., and cost if known.

STRUCTURE

Location - Northern Tip of Reservation
Date of Transfer - 20 August 1907
Cost at that Date - \$7,500.00
Type of Construction - 3 Story Frame Bldg.
(a) Roof - Wood Framing - Rubberoid roofing
(b) Remainder of Bldg. - Wood Framing,
Galv. iron siding
How concealed - Painted gray
How protected - None

UTILITIES

Characteristics: Voltage - 115 DC; Phase 1Ø
Type of Lighting Fixtures - Commercial Std. - CSF
Heat
How heated - 2 stoves

Water Sewer

Connected to Water Main - Yes
Connected to Sewer - Septic Tank
Type of Latrine - None (Lavatory)
Elevation of site - Mean Low Water - El. 12.0

INSTRUMENTS & EQUIPMENT

Type of Instrument - 60" Searchlight installed
by others.

DATA TRANSMISSION

Type - Telephone

REMARKS

This structure was originally constructed as supplementary stations: (a) F¹ No. 1
(b) F¹ No. 2
(c) B¹ (Alexander)

The station at that time was a 3 story Frame Bldg.
1st Floor, 1 room 16' x 40' with Lavatory
2nd Floor, 1 room 16' x 40'
3rd Floor, Corridor & 3 Observing Rooms
12' x 16', 9' x 15' and 12' x 16'
Reference of Instruments - El. 44.52 M.L.W.
El. 40.03 M.L.W.
El. 40.02 M.L.W.

17 November 1916

Structure abandoned as supplementary Fire Control Station and top observing room modified and utilized for searchlight mounting.

1943

Top floor roof raised, field of view of searchlight increased by installing rolling steel shutters on two sides of top floor. Second floor, which is now Control Room altered. Searchlight formerly No. 5 now mounted on top floor.....\$ 2,653.83

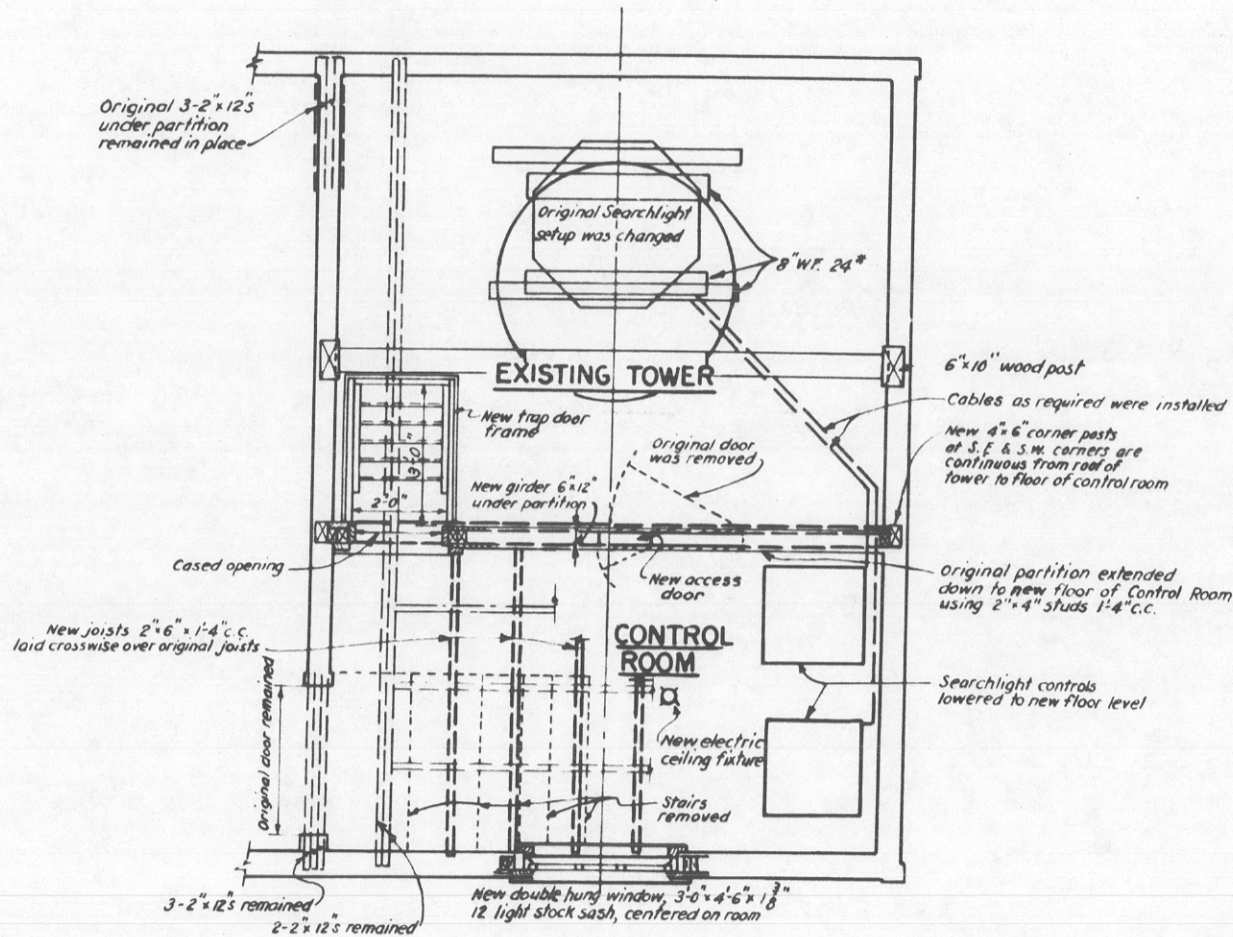

SECTIONAL PLAN

NOTE

Elevations refer to Mean Low Water Datum

HARBOR DEFENSES OF NEW YORK
 FIRE CONTROL STATION
 SEARCHLIGHT NO. 7
 FORT HANCOCK NEW JERSEY

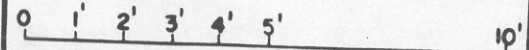

SECRET

REPORT OF COMPLETED WORKS - SEACOAST FORTIFICATIONS.
(Fire control and torpedo structures)

COAST DEFENSES OF Sandy Hook
FORT Hancock, N.J.

Form 2 Corrected to July 1, 1921

STRUCTURE Shelter for Cadillac searchlight power units.

Location	: About 300 ft. southerly : : from emp.#2- Battery Peck :	Type of data transmission	: -
Date of transfer	: March 24, 1921	Date of transfer	: -
Cost to date	: \$1,050.00	Cost of data transmission	: -
Type of construction	:	equipment.	:
(a) Roof	: 3 ply Barrett on wood	For tide stations give	: -
(b) Remainder of building	: Frame; corrugated abbestos siding	description of tide	:
How concealed	: None	gauge.	:
How protected	: None	For datum points give Forts:	-
Height above concealment	: -	from which visable	:
Height above protection	: -	For dormitories give sta-	-
Conspicuous at 5000 + yards	: Yes	tions served	:
Source of electric current	: Pumping station	For cable hut give S. C. type:	-
Kilowatts required	: .2 K.W.	:	:
Type of lighting fixtures	: Drop lights	:	:
How heated	: No heat	:	:
Connected to water mains	: NO	:	:
Connected to sewer	: NO	:	:
Type of latrine	: None	:	:
Permanent or temporary installation	: Permanent	:	:
Present condition	: Good	:	:
Reference of site	: 9.7 ft. above	:	:
Reference of instrumental axis	: -	:	:
Type of observing instrument	: -	:	:
Type of plotting board	: -	:	:
Type and capacity of crane	: -	:	:
Max. dimensions of reel handled	: -	:	:

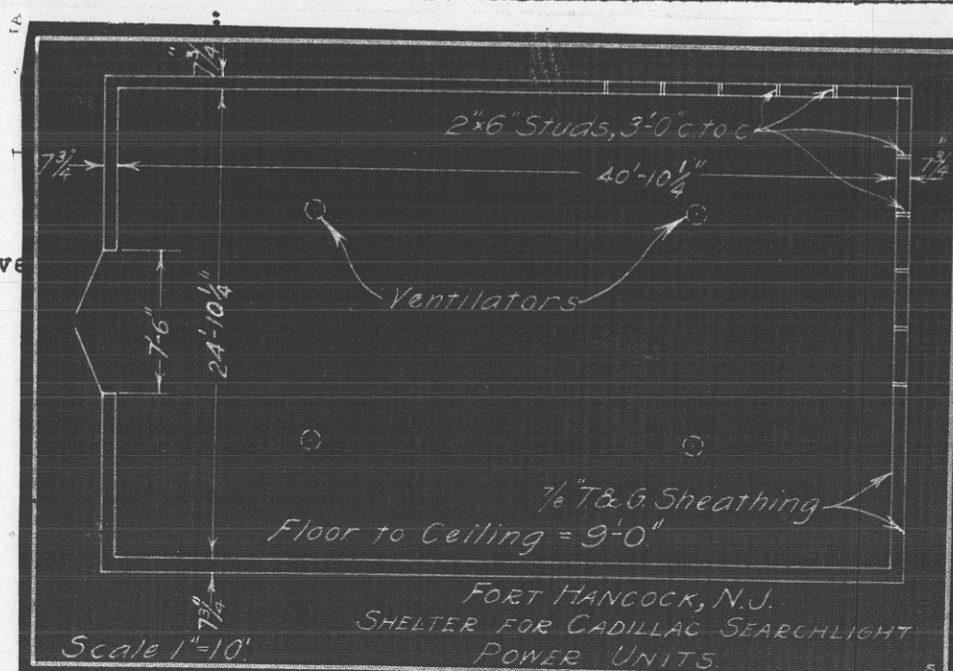

REPORT OF COMPLETED WORKS - SEACOAST FORTIFICATIONS.
(Fire control and torpedo structures)

COAST DEFENSES OF Sandy Hook

FORT Hancock, N.J.

Form 2 Corrected to July 1, 1921

STRUCTURE Shelter for Cadillac searchlight power units.

Location	: About 300 ft. southerly : : from emp.#2- Battery Peck : : : : :	Type of data transmission	: - : : :
Date of transfer	: March 24, 1921	Date of transfer	: -
Cost to date	: \$1,050.00	Cost of data transmission	: -
Type of construction	: :	equipment.	: :
(a) Roof	: 3 ply Barrett on wood	For tide stations give	: -
(b) Remainder of building	: Frame; corrugated abbestos siding	description of tide	: :
How concealed	: None	gauge.	: :
How protected	: None	For datum points give Forts:	: -
Height above concealment	: -	from which visable	: :
Height above protection	: -	For dormitories give sta-	: -
Conspicuous at 5000 + yards	: Yes	tions served	: :
Source of electric current	: Pumping station	For cable hut give S. C. type:	: -
Kilowatts required	: .2 K.W.	: :	: :
Type of lighting fixtures	: Drop lights	: :	: :
How heated	: No heat	: :	: :
Connected to water mains	: NO	: :	: :
Connected to sewer	: NO	: :	: :
Type of latrine	: None	: :	: :
Permanent or temporary installation	: Permanent	: :	: :
Present condition	: Good	: :	: :
Reference of site	: 9.7 ft. above	: :	: :
Reference of instrumental axis	: -	: :	: :
Type of observing instrument	: -	: :	: :
Type of plotting board	: -	: :	: :
Type and capacity of crane	: -	: :	: :
Max. dimensions of reel handled	: -	: :	: :

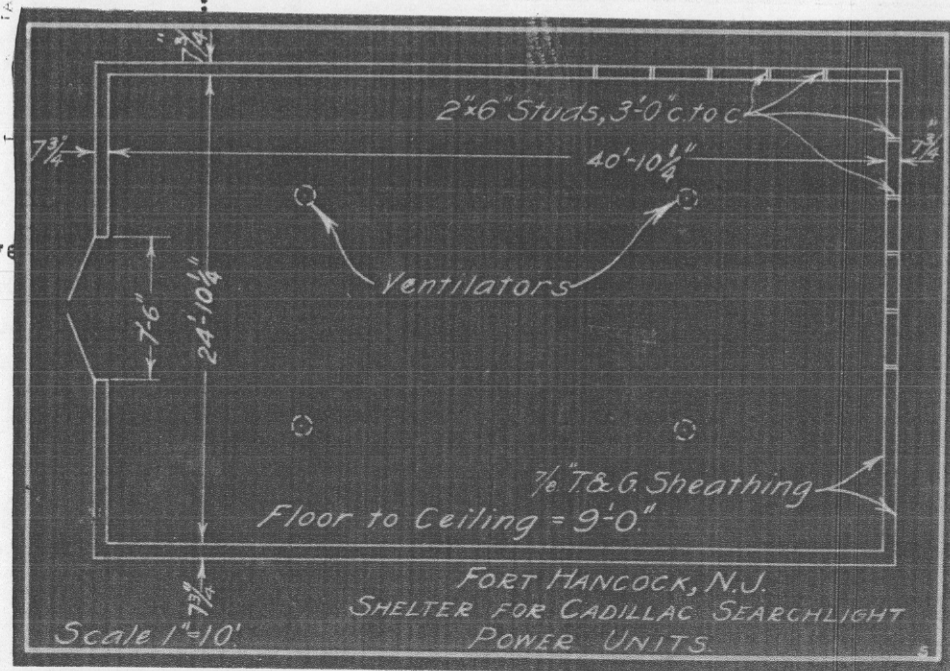

600.914(9) 86378
REPORT OF COMPLETED WORKS - SEACOAST FORTIFICATIONS.

HARBOR DEFENSES OF NEW YORK
FORT HANCOCK, NEW JERSEY

Part VI

Corrected to 30, MARCH 1944

ENGINEER DEPARTMENT STRUCTURES
STRUCTURE - SEARCHLIGHT PLATFORM

On this sheet list any existing structures of a permanent or semipermanent nature used wholly or in part by the Engineer Department, such as wharves, storehouses, quarters, office buildings, railroads and railroad equipment, giving for each a short description, dimensions, materials of construction, present use, location, etc., and cost if known.

SPEKIM-1

STRUCTURE:

Location (by coordinates) Special Lambert System
Center of Platform
x E-300,490.794 ft.
y N-170,703.792 ft.

Location (by site description)
Northeast section of Reservation.

Date of transfer - 22 September 1943.

Cost to that date - \$638.55

Type of Construction

(a) Roof - None

(b) Remainder of Structure - Timber

How concealed - None

How protected - None

UTILITIES:

Electric Power - None

REFERENCE:

Reference of site - Mean Low Water.

Platform for 60" Searchlight furnished by others.

SECRET

92-4882

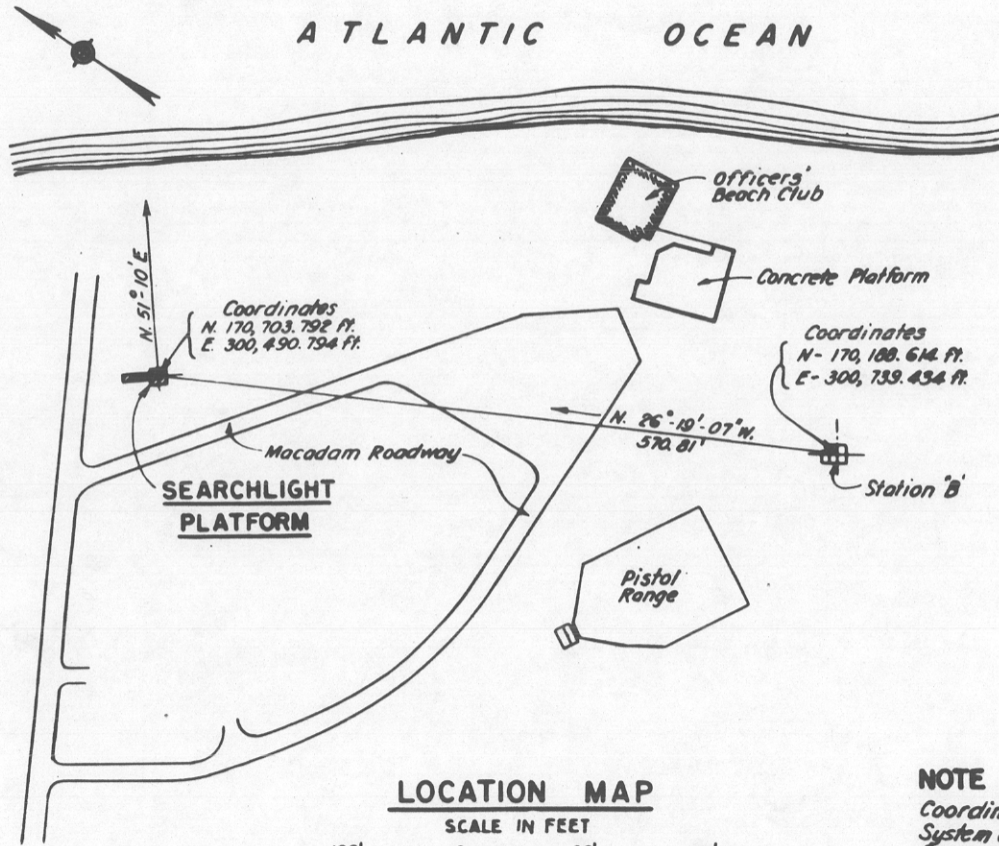

LOCATION MAP

SCALE IN FEET



NOTE

Coordinates refer to the Special Lambert System as determined by the U.S.C. & G.S. for Sandy Hook, New Jersey.

HARBOR DEFENSES OF NEW YORK

SEARCHLIGHT PLATFORM

FORT HANCOCK

NEW JERSEY

SECRET

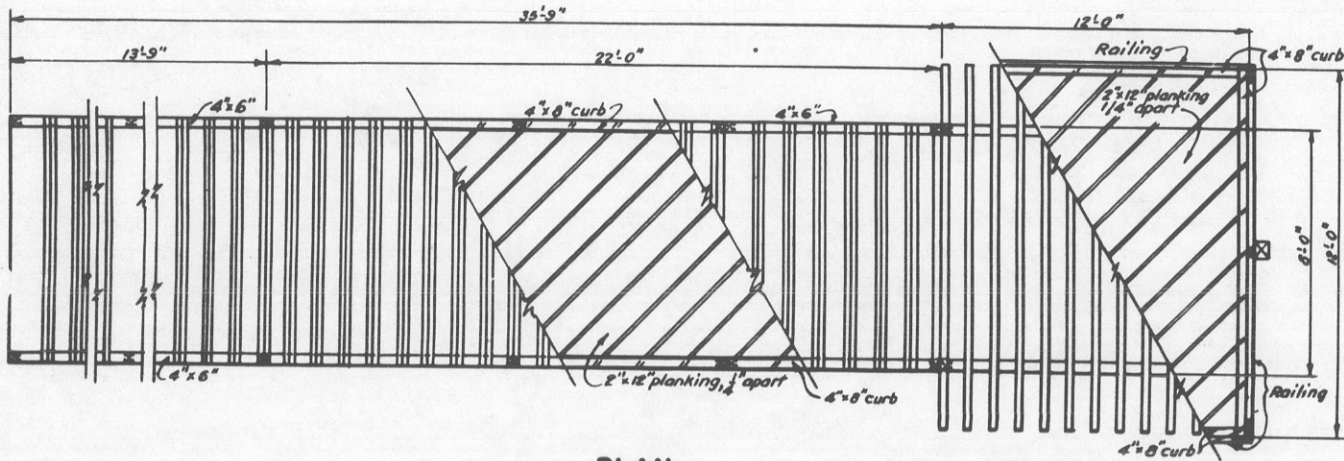

PLAN

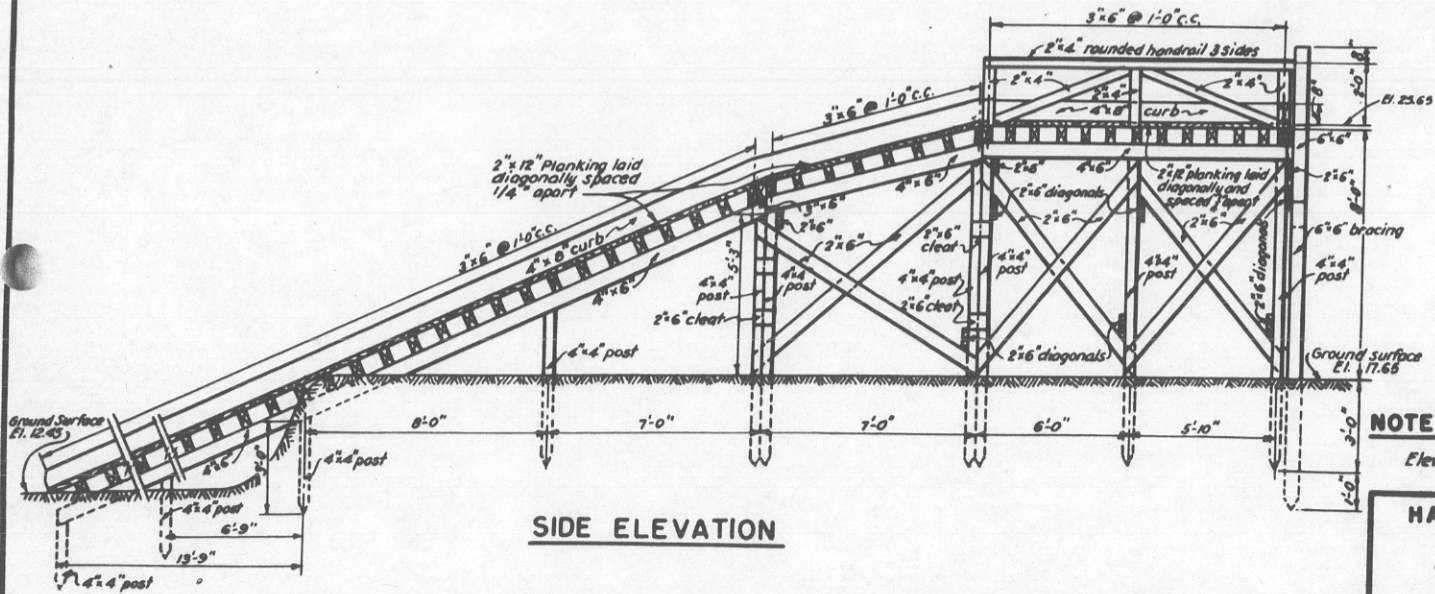

SIDE ELEVATION

NOTE

Elevations refer to Mean Low Water Datum

HARBOR DEFENSES OF NEW YORK
SEARCHLIGHT PLATFORM
PLAN AND DETAILS
FORT HANCOCK NEW JERSEY

0 2' 4' 6' 8' 10'

SECRET

-600,914 (New York) CM 63166

REPORT OF COMPLETED WORKS - SEACOAST FORTIFICATIONS.

HARBOR DEFENSES OF NEW YORK
FORT HANCOCK

Part VI Corrected to 15 October 1943

ENGINEER DEPARTMENT STRUCTURES
STRUCTURE - STORAGE BLDG. FOR PORTABLE SEARCHLIGHTS

On this sheet list any existing structures of a permanent or semipermanent nature used wholly or in part by the Engineer Department, such as wharves, storehouses, quarters, office buildings, railroads and railroad equipment, giving for each a short description, dimensions, materials of construction, present use, location, etc., and cost if known.

SPEKM-1

STRUCTURE:

Location
Date of transfer
Cost to that date
Type of construction
(a) Roof
(b) Remainder of bldg.
(c) Footings
How concealed
How protected
Conspicuous atyards

Northeast section of
Reservation.
20 July 1943.
\$10,677.40
Sheet Metal
Sheet Metal
Concrete
None
None
700

ELECTRIC CURRENT:

Source of
Kilowatts required
Type of lighting fixtures

Commercial power
2.0
Commercial standard C.S.F.

HE

How heated

Coal stoves

WATER & SEWER:

Connected to water mains
Connected to sewer
Type of latrine

No
No
None

REFERENCE:

Reference of site
Type and capacity of crane

Mean Low Water
None

SECRET

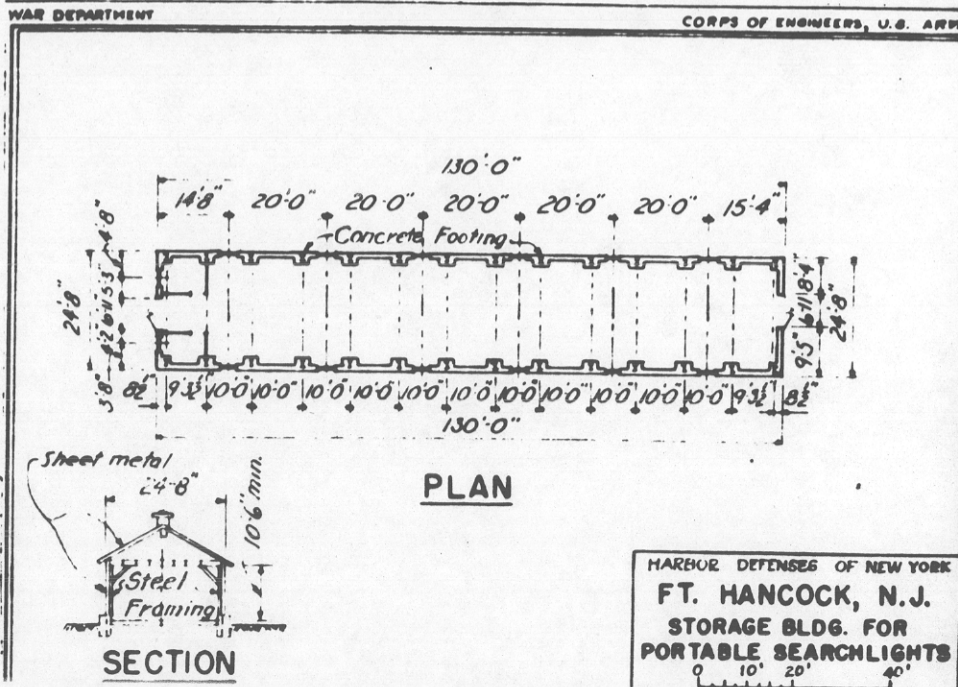

PLAN

SECTION

HARBOR DEFENSES OF NEW YORK
FT. HANCOCK, N.J.
STORAGE BLDG. FOR
PORTABLE SEARCHLIGHTS
0 10' 20' 40'

2291

REPORT OF COMPLETED WORKS - SEACOAST FORTIFICATIONS
(Searchlights)

Form 4.

Corrected to July 13, 1928.

Assignment of Tactical No. 4 to R.R. S/L approved by A.G.
July 2, 1929, 17th ind. C. of E. 660 K (S.H.) 100

HARBOR DEFENSES OF Sandy Hook
FORT Hancock

SEARCHLIGHT NO. 4 { 9th ind. 660 K (S.H.) 100. This office recommended
① = 4 on R.R. Car { this S/L be assigned Tactical No. 4 - April 1929.
Size 60" Portable on R.R. car.
(Drum type searchlight, 150 amps.) Tactical No. 4

<u>PROJECTOR</u>	: On S.L. Car at Fort	: <u>INSTALLATION</u>	:
Location	: Hancock.	: General character	: R.R. Searchlight Car.
	: (Stored in Engr. Car Shed at Post)	: Date transferred to	:
Manufacturer	: General Electric Co.	: troops (Fort Hancock)	: 1/11/21
Type of projector	: E.C. 60"	: Cost to that date	: No record
Form of projector	: N. 6.	: Shelter	: Wooden
Serial No. of projector	: 9363 DL 116796-2	: Materials of construction	: Wood
Type of lamp	: Sperry Gyroscope Co., N.Y.	: Interior dimensions	: 96' x 16' x 12' high
Model of lamp	: 9 Mark V	: Height and type of tower	: 21.03' steel tower on flat car
Serial No. of lamp	: 307	:	: (Total height above rail to center
Electric or hand control	: Electric	:	: of S.L.) (tower in operating
Material of mirror	: Glass	:	: position, 33.46').
Date received in district	: Jan. 11, 1921.	: Means by which projector	:
From whom received	: Camp Eustis, Va.	: is placed in operating	:
Age of mirror	: Original mirror, Age not known.	: Position	: Hand power
Condition of mirror	: Excellent	: Reference axis of projector	:
Date last repaired	: No repairs	: in operating position	: Horizontal position.
Switchboard, Serial No.	: No number	: Kind of protection in	:
	: (Circuit Breakers (2) No. 18 Cat. 36246 No. DL 126758)	: operating position	: No protection except portability.
<u>CABLES #</u>		: Concealment of day shelter	: In low spot back of Battery
Power plant to searchlight:		: from approach channel	: Urnston and back of sand dunes.
Type	: Flexible	: Dates & cost of extensive	:
Length and size	: Length 75' (approx.) Size unknown	: remodeling or reconstruction	: No record.
In conduits or in air	: Majority in conduit	: No repairs at this station.	:
Controller to light	: --	<u>POWER PLANT</u>	:
Type	: R.C. and braided.	: Location	: In specially built box car.
Length and size	: Abt. 1000' 9 cond. each Cond. 2243 cm.	: Maximum demand KW	: 17.5 K.W.
In conduit or in air	: In air.	: Type and size	: G.E. 25 K.W. (2 units)
Aux. controller to light	: None	<u>CONTROLLERS</u>	:
Length and size	: --	: Location	: Portable (on flat car at present).
In conduit or in air	: --	: Type	: G.E. DL 83534
① See 1st ind., 470.31A-2345, 2/28/39		: Form	: P
Now designated # 4 on R.R. Car.		: Serial No.	: 6291
		: How protected or concealed	: Housed in car (portable controllers

Shipped to Ft. Hancock, C.D. of Sandy Hook, Aug. 5, 1920, on Govt. B/L 522523, C. of E. 470.35 (N.Y.) 19
Photo. of this unit in G.E. REVIEW, Sept. 1919 pp 691 & 692

HEADQUARTERS HARBOR DEFENSES OF SANDY HOOK
OFFICE OF THE HARBOR DEFENSE COMMANDER

File: 470.3 S.L.

Fort Hancock, New Jersey,
February 27, 1929.

Subject: Replacements made of Rail Road Searchlight, at Fort Hancock, N.J.

To: OFFICE OF THE CHIEF OF ENGINEERS, Washington, D.C. (Thru
Commanding General, 2nd Coast Artillery District, Ft. Totten, N.Y.)

1. The following report is rendered on the repair of the Rail Road Searchlight Projector and its equipment, at this post:

(a) The replacement of the base, base rollers and traversing apparatus on the Rail Road Searchlight, projector number 9363, type E.C. Form N-6, has been completed. The entire projector and all its parts are now working in a very satisfactory manner. The entire base system was used, of the one sent here from Fort Monroe, Va., except the training motor system. The modification made by the Artillery Engineer, of this Harbor Defenses, did not change any numbers that were a part of your records. The present record of this searchlight is as follows:

(b) Size, 60" type E.C. Form N-6, with domestic mirror.
Tactical number as per approved project, None. (Provisional No. 4)
Stored in U.S. Engineer, Railroad Car Shed, at this post.
Tactical use, (Provisional Searching).
Serial number, G.E. 9363, type E.C. Form N-6, (A modified N-5).
Rack and pinion at time of delivery at this post 8-pitch, instead of 12.
When purchased, not known at this post.
Received in this harbor defense from Fort Monroe, Va. 1/11/21.
Controller number 6291, Form N-2, 9 wire. (1050 ft cable on hand).

J. C. Johnson,
Colonel, 7th Coast Artillery,
Commanding.

No. Incls.

(To C.G., 2d C.A.)
Pencil Note. (It is requested that this paper be referred
to the 3d District Engineer and then forwarded
to the Chief of Engineers.)

See 470.31-4 7-39-2nd ind. May 12, 1930, par. 1(a)

470.3

1st Ind.

4 March, 1929 - To Commanding General, 2nd Corps Area, Governors Island, N.Y.

It is requested that this paper be referred to the 3rd District Engineer and then forwarded to the Chief of Engineers.

S. Heintzelman,
Brigadier General, U.S.A.

470.3 HD SH (EO)

2nd Ind.

March 7, 1929. - To: District Engineer, 3rd New York District, 39 Whitehall Street, New York City.

To note and forward to the Chief of Engineers.

For the Commanding General:

BYARD SNEED
Major, A.G.D.
Assistant Adjutant General.

Han. 15/200.8

3rd Ind.

U.S.E.O., 3rd Dist., N.Y.C., Mar. 14, 1929. - To The Chief of Engineers, U.S. Army. THROUGH THE DIVISION ENGINEER, NORTHEAST DIVISION.

Noted.

By direction of The District Engineer:

Reading Wilkinson
Captain, Corps of Engineers.