

- LEGEND**
- Light outlets.
 - ⊙ Plotting Board lights.
 - ⊕ Junction boxes.
 - ⊖ Drain outlets.

REVISIONS	FORT HANCOCK, N. J. HARBOR DEFENSES OF SANDY HOOK DRAINAGE & ELECTRIC SYSTEMS BATTERY GRANGER	
	SCALE 1 INCH = 10 FEET	
	Headquarters Second Corps Area, Office of Engineer Governors Island, N.Y., July 20, 1931.	
	Submitted by <i>A. Millerwood</i> Associate Engineer, Electrical.	Approved by <i>W. J. Barden</i> Colonel, Corps of Engineers, Corps Area Engineer.
	Drawn by <i>B. J.</i>	Transmitted with letter dated 1931.
	Checked by <i>H. P. U.</i> File No.	

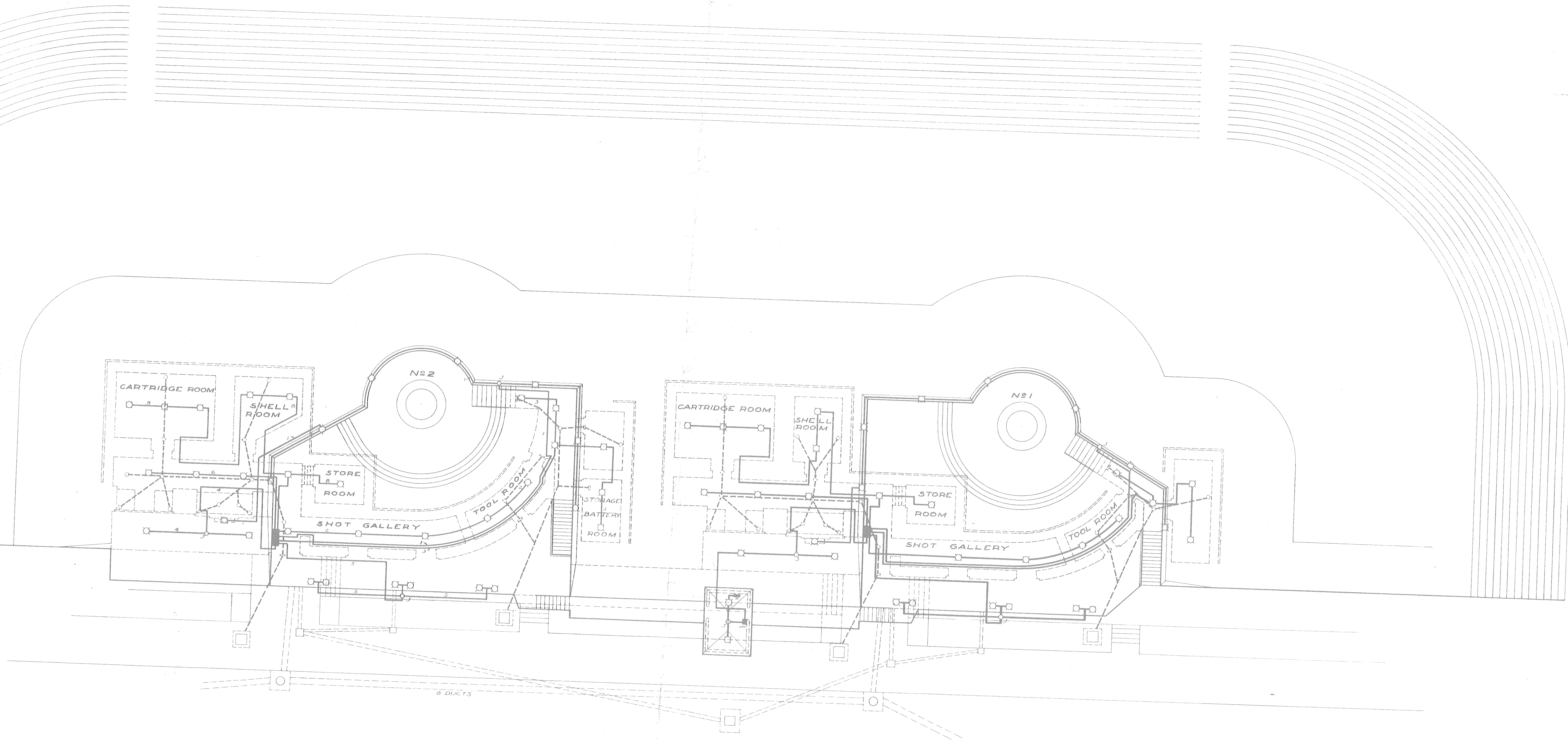

- LEGEND
- Light outlets.
 - ⊗ Plotting Board lights.
 - ⊕ Junction boxes.
 - ⊖ Drain outlets.

REVISIONS	<p align="center">FORT HANCOCK, N. J. HARBOR DEFENSES OF SANDY HOOK DRAINAGE & ELECTRIC SYSTEMS BATTERY GRANGER SCALE 1 INCH = 10 FEET</p> <p>Headquarters Second Corps Area, Office of Engineer Governors Island, N.Y., July 20, 1931.</p> <p>Submitted by <i>D. Millerwood</i> Associate Engineer, Electrical. Approved by <i>W. J. Kinsler</i> Colonel, Corps of Engineers, Corps Area Engineer.</p> <p>Drawn by <i>B. Y.</i> Checked by <i>L. L. U.</i> File No. _____ Transmitted with letter dated _____ 1931.</p>
------------------	--

01733
32210
555

32210
555

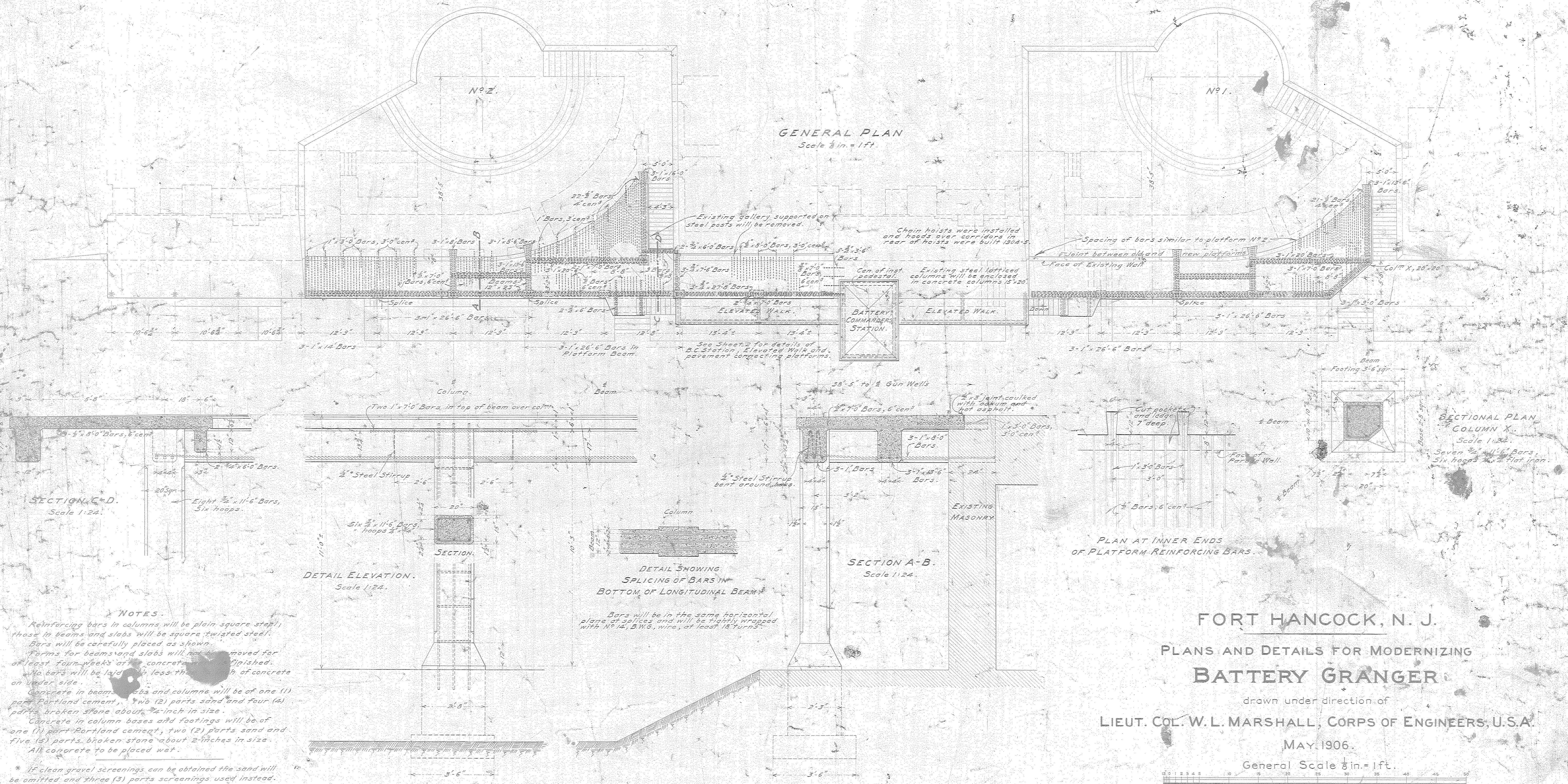

NOTES.

Reinforcing bars in columns will be plain square steel; those in beams and slabs will be square twisted steel. Bars will be carefully placed as shown.

Forms for beams and slabs will not be moved for at least four weeks after concrete is finished. No bars will be laid on less than 1/2 inch of concrete on under side.

Concrete in beams, slabs and columns will be of one (1) part Portland cement, two (2) parts sand and four (4) parts broken stone about 3/4 inch in size.

Concrete in column bases and footings will be of one (1) part Portland cement, two (2) parts sand and five (5) parts broken stone about 2 inches in size. All concrete to be placed wet.

* If clean gravel screenings can be obtained the sand will be omitted and three (3) parts screenings used instead.

Bars will be in the same horizontal plane at splices and will be tightly wrapped with No. 14, B.W.G. wire, at least 18 turns.

Forwarded to the Chief of Engineers, U.S.A., with letter dated May 24, 1906.

Lieut. Col., Corps of Engineers, U.S.A.

FORT HANCOCK, N. J.

PLANS AND DETAILS FOR MODERNIZING BATTERY GRANGER

drawn under direction of
LIEUT. COL. W. L. MARSHALL, CORPS OF ENGINEERS, U.S.A.

MAY, 1906.

General Scale 3/8 in. = 1 ft.

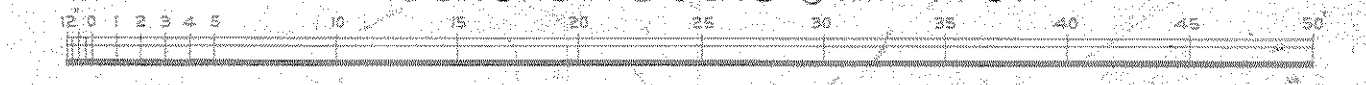

Detail Scale 1:24.

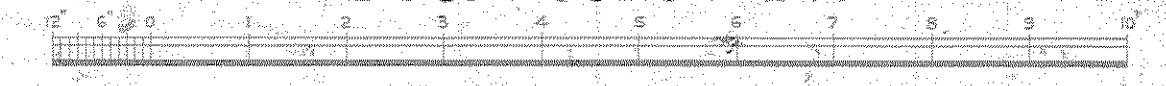

IN TWO SHEETS - SHEET NO. 1

SHEET I: PLAN AND DETAILS OF PLATFORM EXTENSIONS.